

1030 M & M WATER TIGHT EXPANSION COUPLERS

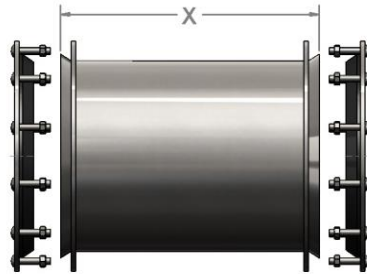

1030 Coupler Part No.	Nominal Pipe O.D. (Z)	Length (X)	Ring O.D. (Y)	Carriage Bolt Size	No. of Bolts per Coupler	Weight
1030-03D	3.000"	16.00"	6.250"	3/8" X 2-1/2"	8	16.00 lbs.
1030-03I	3.500"		6.250"		8	16.00 lbs.
1030-04D	4.000"		7.250"		10	19.00 lbs.
1030-04I	4.500"		7.250"		10	19.00 lbs.
1030-05D	5.000"	18.00"	8.188"		12	22.00 lbs.
1030-05I	5.563"		8.188"		12	22.00 lbs.
1030-06D	6.000"		8.250"		12	27.00 lbs.
1030-06I	6.625"		9.125"		14	27.00 lbs.
1030-06P	6.140"		8.750"		12	26.00 lbs.
1030-08D	8.000"		10.813"		16	35.00 lbs.
1030-08I	8.625"		11.375"		16	35.00 lbs.
1030-08P	8.160"		10.813"		16	35.00 lbs.
1030-10D	10.000"		12.813"		20	44.00 lbs.
1030-10I	10.750"		13.688"		20	44.00 lbs.
1030-10P	10.200"	12.813"	20		44.00 lbs.	
1030-12D	12.000"	20.00"	15.438"		3/8" X 3"	24
1030-12I	12.750"		15.875"	24		52.00 lbs.
1030-12P	12.250"		15.438"	24		52.00 lbs.
1030-14D	14.000"		17.000"	28		50.00 lbs.
1030-15P	15.300"		18.250"	28		58.00 lbs.
1030-16D	16.000"		19.000"	32		65.00 lbs.
1030-180D	18.000"		21.188"	36		77.00 lbs.
1030-183P	18.360"		21.188"	36		77.00 lbs.
1030-187P	18.700"		21.750"	36		82.00 lbs.
1030-20D	20.000"		23.500"	40		88.00 lbs.
1030-20P	20.400"	23.500"	40	90.00 lbs.		
1030-22P	22.047"	25.250"	1/2" x 4"	44	97.00 lbs.	
1030-24D	24.000"	28.000"		48	110.00 lbs.	
1030-24P	24.803"	28.000"		48	110.00 lbs.	
1030-27P	27.953"	31.500"		56	135.00 lbs.	
1030-31P	31.496"	35.750"	60	165.00 lbs.		

- Use E/G/S after Part # to indicate Epoxy/ Galvanized/ 304 Stainless Steel.
- Bodies are 11 GA. Material.
- Rings are 5/16" Thick on Carbon Steel 1/4" Thick on Stainless Steel.
- Pressure Rating of 150 PSI.

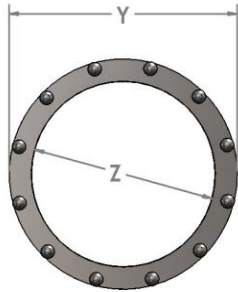