

1526 Flanged Reducing Spool

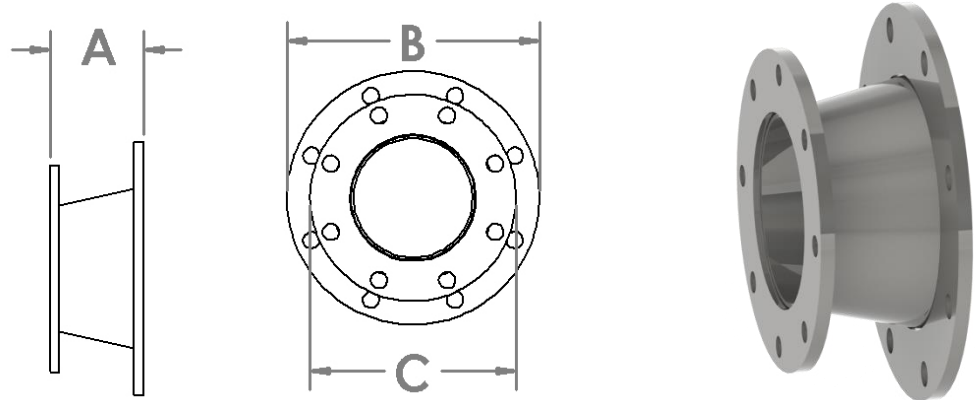

Part No.*	Flange Size	Length (A)	Flange O.D. (B)	Flange O.D. (C)	Approx. Weight
1528-0403	4" x 3"	4.50"	9.00"	7.50"	12.0 lbs.
1528-0503	5" x 3"	4.50"	10.00"	7.50"	15.0 lbs.
1528-0504	5" x 4"	4.50"	10.00"	9.00"	16.0 lbs.
1528-0604	6" x 4"	4.50"	11.00"	9.00"	20.0 lbs.
1528-0605	6" x 5"	4.50"	11.00"	10.00"	22.0 lbs.
1528-0805	8" x 5"	6.50"	13.50"	10.00"	28.0 lbs.
1528-0806	8" x 6"	4.50"	13.50"	11.00"	28.0 lbs.
1528-1006	10" x 6"	7.00"	16.00"	11.00"	35.0 lbs.
1528-1008	10" x 8"	4.50"	16.00"	13.50"	35.0 lbs.
1528-1208	12" x 8"	7.00"	19.00"	13.50"	45.0 lbs.
1528-1210	12" x 10"	4.50"	19.00"	16.00"	43.0 lbs.

- *Use E/G/S after Part Number to indicate Epoxy, Galvanized or Stainless Steel.
- 10 Gauge Cones from Pipe conforms to ASTM A153 Grade B.
 - 304 SST conforms to ASTM A778/A312.
- 10 Gauge Cones Hot Rolled Sheet conforms to ASTM A36.
- 1/2" Thick Plate Flanges conform to ASTM A105.
 - 304 SST to ASTM A182 with Drill Pattern to ASME/ANSI Class 150.
- Galvanized Coating conforms to ASTM A123.
- Epoxy Coating conforms to AWWA standards C116, C213 & C5500, certified ANSI/NSF 61.

