

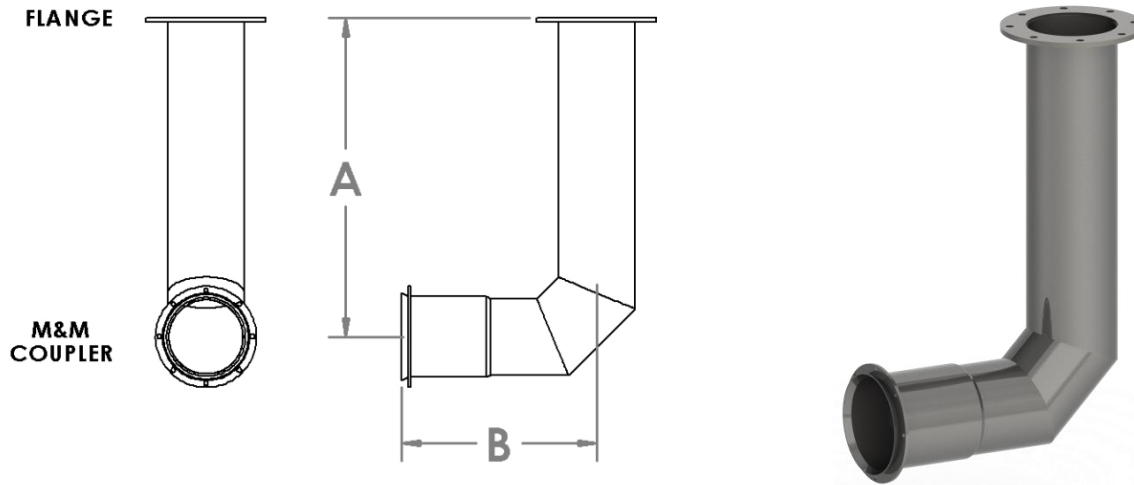

**1520 90° Discharge Elbow
Flange x M&M Coupler**



Part No.*	Flange Size	M&M Coupler Size	Length (A)	Length (B)	Approx. Weight
1520-0404I	4"	4" IPS	36.00"	19.00"	34 lbs.
1520-0405I	4"	5" IPS	36.00"	21.00"	37 lbs.
1520-0406I	4"	6" IPS	36.00"	23.00"	40 lbs.
1520-0406P	4"	6" PIP	36.00"	23.00"	40 lbs.
1520-0505I	5"	5" IPS	36.00"	19.00"	43 lbs.
1520-0506I	5"	6" IPS	36.00"	21.00"	47 lbs.
1520-0506P	5"	6" PIP	36.00"	21.00"	47 lbs.
1520-0606I	6"	6" IPS	36.00"	19.00"	57 lbs.
1520-0606P	6"	6" PIP	36.00"	19.00"	57 lbs.
1520-0608I	6"	8" IPS	36.00"	23.00"	63 lbs.
1520-0608P	6"	8" PIP	36.00"	23.00"	63 lbs.
1520-0808I	8"	8" IPS	36.00"	22.50"	75 lbs.
1520-0808P	8"	8" PIP	36.00"	22.50"	75 lbs.
1520-0810I	8"	10" IPS	36.00"	26.50"	81 lbs.
1520-0810P	8"	10" PIP	36.00"	26.50"	81 lbs.
1520-0812I	8"	12" IPS	36.00"	28.50"	88 lbs.
1520-0812P	8"	12" PIP	36.00"	28.50"	88 lbs.
1520-1010I	10"	10" IPS	36.00"	22.50"	94 lbs.
1520-1010P	10"	10" PIP	36.00"	22.50"	94 lbs.



**1520 90° Discharge Elbow
Flange x M&M Coupler**

1520-1012I	10"	12" IPS	36.00"	26.50"	100 lbs.
1520-1012P	10"	12" PIP	36.00"	26.50"	100 lbs.
1520-1015P	10"	15" PIP	36.00"	28.50"	106 lbs.
1520-1212I	12"	12" IPS	36.00"	22.50"	116 lbs.
1520-1212P	12"	12" PIP	36.00"	22.50"	116 lbs.
1520-1215P	12"	15" PIP	36.00"	28.50"	121 lbs.

- *Use G or S after Part to indicate Galvanized or Stainless Steel.
- 10 Gauge Pipe is IPS & Conforms to ASTM A153 Grade B/304 S/S Conforms to ASTM A778/A312.
- 1/2" Thick Plate Flanges Conform to ASTM A105/ 304 S/S to ASTM A182 w/ Drill Pattern to ASME/ANSI Class 150.
- See M&M Fittings Section for Specifications on Coupler Connection.
- Construction is 3 piece mitered.
- Galvanized Coating conforms to ASTM A123.

