

550 CIRCLE LOCK FEMALE

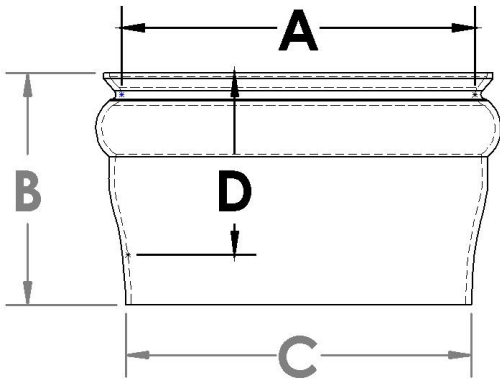

Part No.	Nom. Pipe Size (A)	Dimension		Insertion Depth (D*)	Material Gauge	Approx. Weight
		B	C			
550-05B	5.094"	4.875"	5.000"	3.438"	14 GA.	2.5 lbs.
550-06B	6.094"	5.250"	6.000"	3.875"	14 GA.	3.0 lbs.
550-08B	8.094"	5.250"	8.000"	4.000"	12 GA.	5.0 lbs.
550-10B	10.094"	5.250"	10.000"	4.000"	12 GA.	9.0 lbs.
550-12B	12.094"	5.750"	12.000"	4.000"	12 GA.	11.0 lbs.

- *Morrill Industries Fabricated Male Circle Lock Fittings are designed to be inserted 3.250".
- Circle Lock Female.
- Carbon Steel Fabrication.
- Includes round back Gasket.

