

700 SERIES PRE-FILTER ASSEMBLY

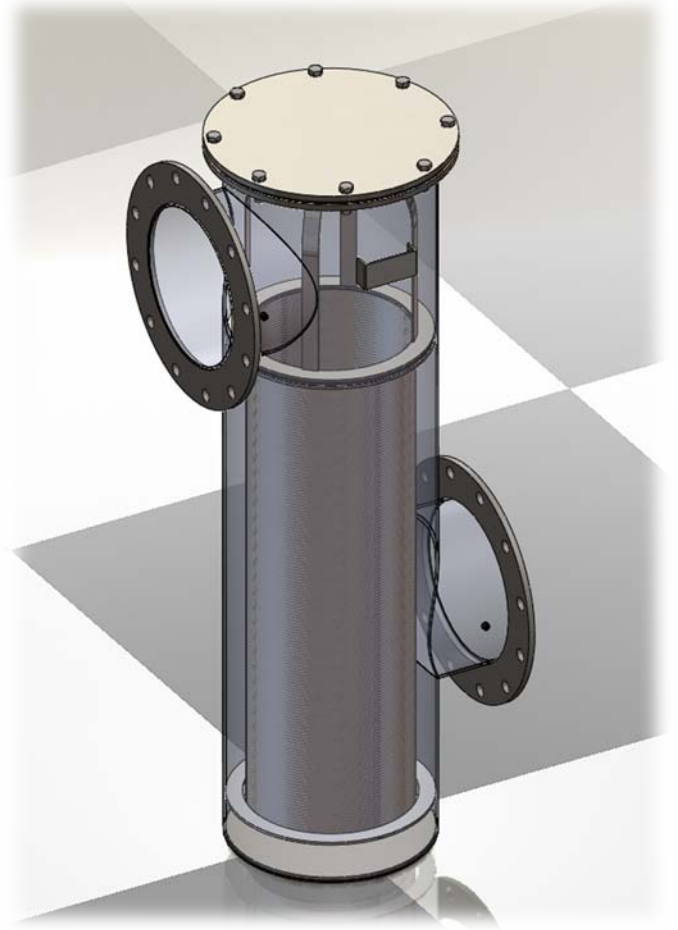

ASSEMBLY PARTS

1. HEX HEAD BOLT
2. FLAT WASHER
3. PRE-FILTER LID
4. LID GASKET
5. PRE-FILTER BASKET
6. BASKET SEAL GASKET
7. PRE-FILTER BODY
8. FLANGE INLET/DISCHARGE

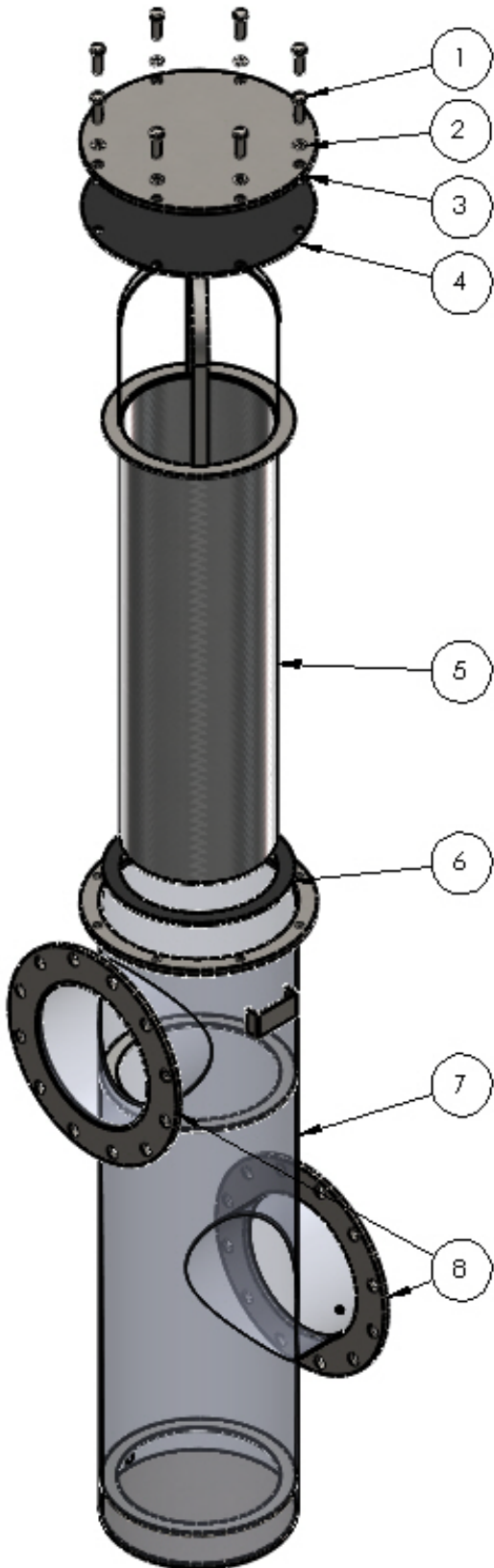



700 SERIES PRE-FILTER ASSEMBLY

MODEL	706	708	710	712	714	716
ITEM	PART NO.					
1	BLT-0620(8)			BLT-0620(12)		
2	BLTS-06F			BLTS-06F		
3	MIPF-01		MIPF-11	MIPF-21		
4	700-RTG		712-RTG	714-RTG		
5	706-RS(X)	708-RS(X)	710-RS(X)	712-RS(X)	714-RS(X)	716-RS(X)
6	MIPF-08		MIPF-18	MIPF-28		
7	706-PFB	708-PFB	710-PFB	712-PFB	714-PFB	716-PFB
8	6"	8"	10"	12"	14"	16"

PRE-FILTERS CAN BE MADE FROM CARBON STEEL W/ GALVANIZE COATING OR 304 STAINLESS STEEL (316 AVAILABLE UPON REQUEST).

MATERIAL SPECIFICATIONS

- 1.) Hex Head Bolts – Grade 5 per SAE J429; or 18-8 Stainless Steel
- 2.) Flat Washers - 18-8 Stainless Steel
- 3.) Pre Filter Lid – Laser Cut/ Carbon Steel ASTM A36; or 304/304L ASTM A240
- 4.) Lid Gasket – ¼" Thick EPDM material.
- 5.) Pre Filter Basket is Construction is ¼" or ½" Perforated Carbon Steel Plate or 304 Stainless Steel.
Handles are 1/8" x 1 ¼" 304 Stainless Steel Material.
- 6.) Basket Seal Gasket is ¼" Thick EPDM material.
- 7.) Body is Carbon Steel Pipe that meets or exceeds ASTM A135 Grade B
304/304L Stainless Steel Pipe conforms to ASTM A778
- 8.) Carbon Steel Flanges meet ASTM A105; 304/304L Stainless Steel Flanges meet ASTM A182
Flanges meet ASME/ANSI Drilling for Class 150

Galvanized Coating Conforms to ANSI A123

Stainless Steel Units finished products have a Matte Sandblast Finish.

