

CONSTRUCTION:

Housing:

ASTM B85 Pressure Die Cast Aluminum
 Polyester Powder Coated

Motor:

Single Phase, Reversible, Permanent
 Split Capacitor Induction Motor, 29Fr

Capacitor:

Metalized Polyester

Spur Gearing:

AGMA class 9, C1144, Induction hardened

Worm Gearing:

Worm: 4140 heat treated, self locking
 Worm Gear: Al-Brz / 303L composite

Bearings:

Shaft: SAE 841 Sintered Bronze Bushing
 Gear: Sealed permanently lubricated ball bearings

Lubrication:

High Temperature Synthetic Grease

Override:

17-4PH Stainless Steel Hardened to H900

Heater:

Optional, 9 Watt PTC style

Terminal Strip:

Basic: 10 - 22 AWG

Servo: 12 - 22 AWG

Torque limiting:

Optional, open and closed preset at factory

Limit Switches: SPDT-DB

120VAC - 10A - 1/2 HP

220VAC - 10A - 3/4 HP

28VDC - 4A INDUCTIVE

28VDC - 6A RESISTIVE

Exposed Fasteners:

Stainless Steel

Travel Stops:

Externally adjustable at both 0 and 90 degrees

Conduit Entries:

Two 3/4" NPT, Optional M25 or PG 16

Weight:

25 lbs.

Enclosure:

NEMA 4, 4X, IP 65

PERFORMANCE:

Output Torque:

800, 1200 and 2000 in.-lbs.

90 Degree travel times: (60 Hz)

6, 10, 15, intermittent, and 30 sec cont.

Gear Ratios:

681:1, 1080:1, 1640:1 and 3336:1

Motor Insulation:

Class F, 170 C Thermal Trip

Voltages:

115V or 230V / 60 or 50 Hz

Temperature:

-40°F to 150°F (-40°C to 65°C)

Duty:

Continuous duty: 30 sec., will operate continuously

at a max. ambient temperature of 104°F (40°C)

Intermittent Duty: 25%, can maintain operation when

cycled; once per four similarly timed rest periods at a max. ambient temperature of 104°F (40°C)

Manual Operation:

Pull to Engage, Push to Disengage

Emergency shut-off, disconnects power to motor

8" diameter handwheel with a 30:1 drive ratio

Optional Spinner available

Rim pull: 18, 28, and 46 lb. respective with torque

Current Draws: (Full Load / Locked Rotor)

	<u>800 in.lb.</u>	<u>1200 in.lb.</u>	<u>2000 in.lb.</u>
115v/6sec	1.4/2.3		
115v/10sec	.78/2.1	1.4/2.3	
115v/15sec	.78/2.1	.78/2.1	1.4/2.3
115v/30sec	.78/2.1	.78/2.1	.78/2.1
220v/6sec	.48/.81		
220v/10sec	.38/.76	.48/.81	
220v/15sec	.38/.76	.38/.76	.48/.81
220v/30sec	.38/.76	.38/.76	.38/.76

SERIES 70

ON / OFF

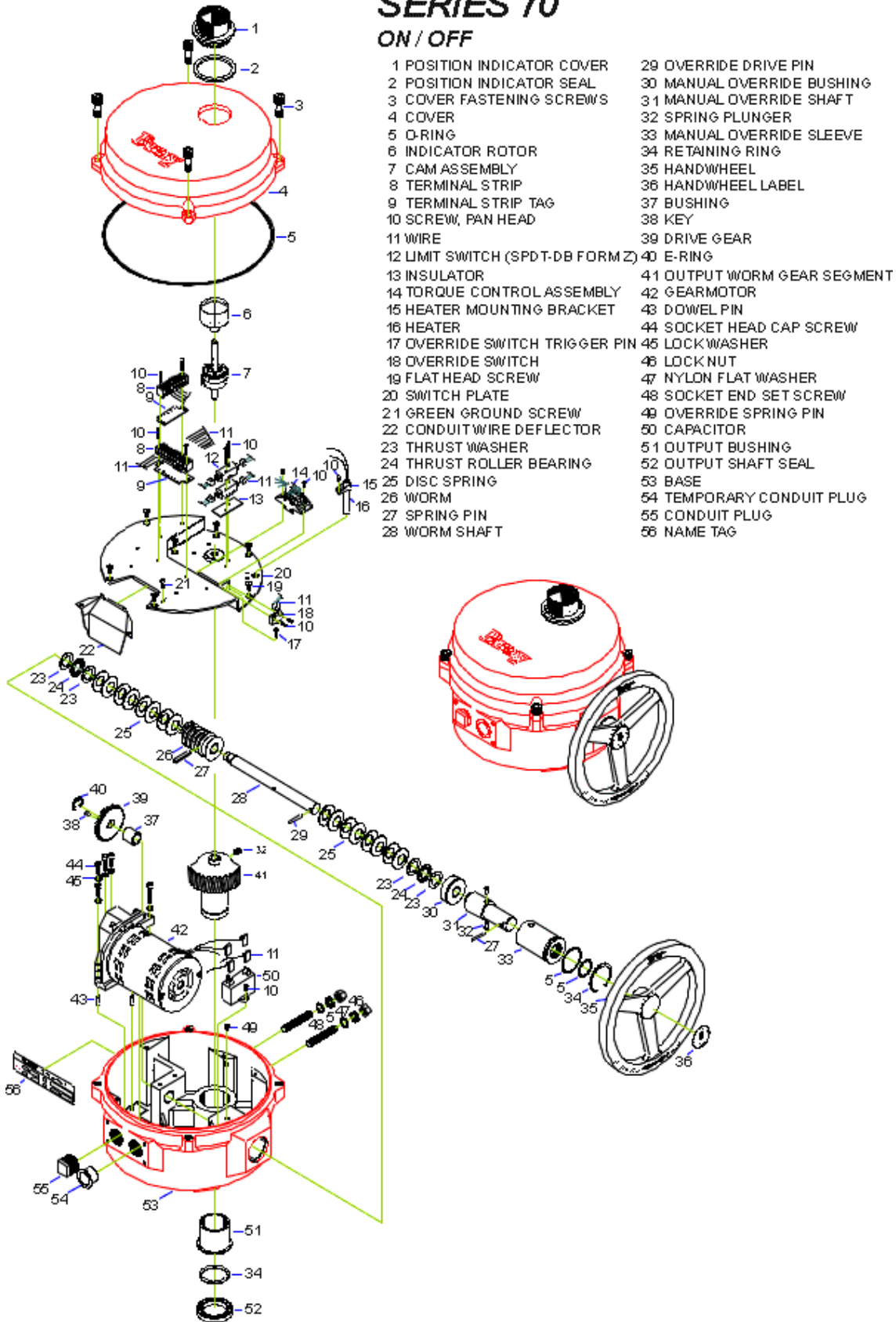

- | | |
|----------------------------------|-----------------------------|
| 1 POSITION INDICATOR COVER | 29 OVERRIDE DRIVE PIN |
| 2 POSITION INDICATOR SEAL | 30 MANUAL OVERRIDE BUSHING |
| 3 COVER FASTENING SCREWS | 31 MANUAL OVERRIDE SHAFT |
| 4 COVER | 32 SPRING PLUNGER |
| 5 O-RING | 33 MANUAL OVERRIDE SLEEVE |
| 6 INDICATOR ROTOR | 34 RETAINING RING |
| 7 CAM ASSEMBLY | 35 HANDWHEEL |
| 8 TERMINAL STRIP | 36 HANDWHEEL LABEL |
| 9 TERMINAL STRIP TAG | 37 BUSHING |
| 10 SCREW, PAN HEAD | 38 KEY |
| 11 WIRE | 39 DRIVE GEAR |
| 12 LIMIT SWITCH (SPDT-DB FORM Z) | 40 E-RING |
| 13 INSULATOR | 41 OUTPUT WORM GEAR SEGMENT |
| 14 TORQUE CONTROL ASSEMBLY | 42 GEARMOTOR |
| 15 HEATER MOUNTING BRACKET | 43 DOWEL PIN |
| 16 HEATER | 44 SOCKET HEAD CAP SCREW |
| 17 OVERRIDE SWITCH TRIGGER PIN | 45 LOCK WASHER |
| 18 OVERRIDE SWITCH | 46 LOCK NUT |
| 19 FLAT HEAD SCREW | 47 NYLON FLAT WASHER |
| 20 SWITCH PLATE | 48 SOCKET END SET SCREW |
| 21 GREEN GROUND SCREW | 49 OVERRIDE SPRING PIN |
| 22 CONDUIT WIRE DEFLECTOR | 50 CAPACITOR |
| 23 THRUST WASHER | 51 OUTPUT BUSHING |
| 24 THRUST ROLLER BEARING | 52 OUTPUT SHAFT SEAL |
| 25 DISC SPRING | 53 BASE |
| 26 WORM | 54 TEMPORARY CONDUIT PLUG |
| 27 SPRING PIN | 55 CONDUIT PLUG |
| 28 WORM SHAFT | 56 NAME TAG |